



12.8V 280Ah LiFePO₄ Battery

FEATURES & BENEFITS



High cycle life

>3000 cycles @80% DoD for effectively lower total cost of ownership.



Built in circuit protection

Battery Management Systems (BMS) are incorporated against abuse.



Light weight

Lithium batteries provide more Wh/Kg while also being up to 1/3 the weight of its SLA equivalent



Extreme heat tolerance

Suitable for use in a wider range of applications where ambient temperature is unusually high: up to +60°C.

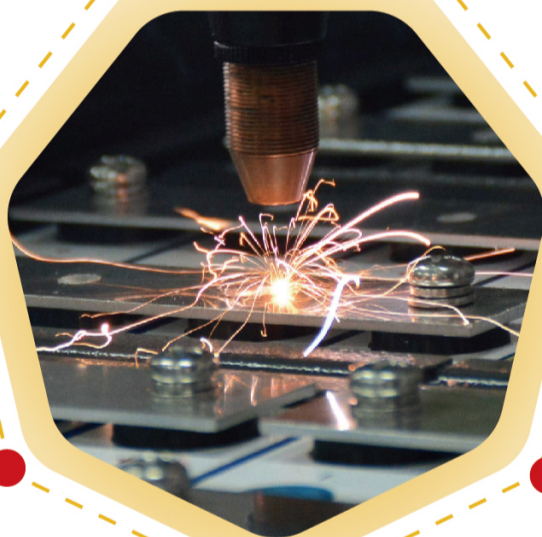

Longer service life

Low maintenance batteries with stable chemistry. Easily monitor state of charge (SoC) of smart models.



Better storage

Up to 6 months thanks to its extremely low self discharge (LSD) rate and no risk of sulphation.



Quickly recharge

Save time and increase productivity with less down time thanks to superior charge/discharge efficiency.

PERFORMANCE CHARACTERISTICS

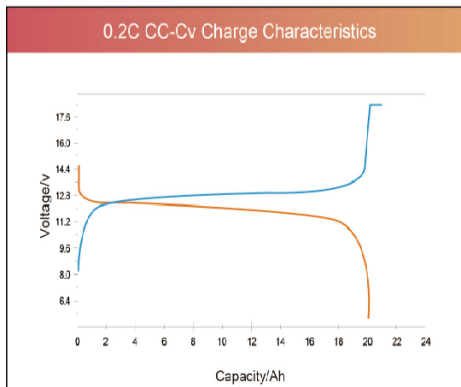
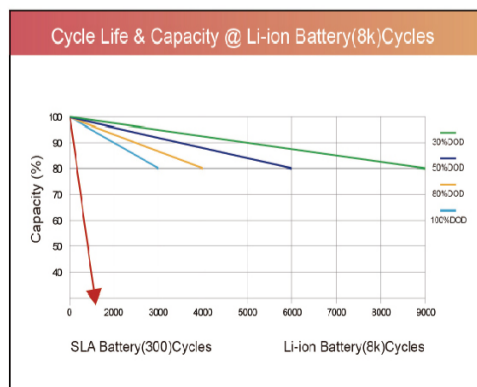
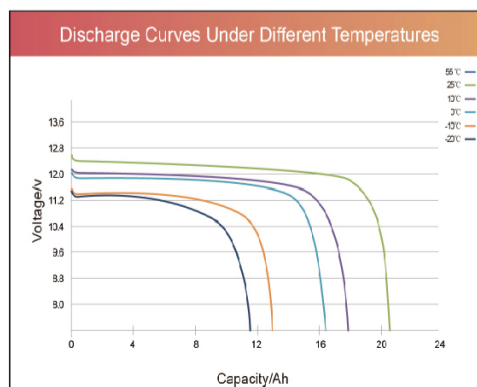
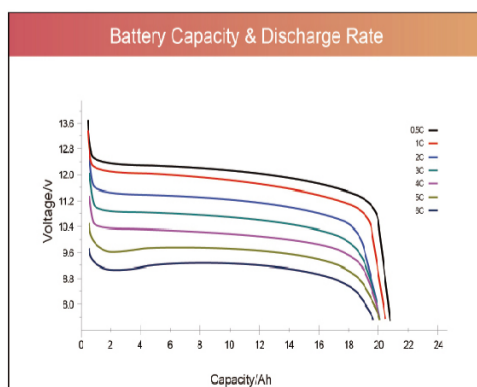



MODEL:GTB-LT-12.8-280

ELECTRICAL PERFORMANCE

Nominal Voltage	12.8V
Nominal Capacity	280Ah
Energy	3584 Wh
Resistance	≤1.204mΩ
Self Discharge	SOC < 3% / Month
Life Cycle	> 3000Cycles

DISCHARGE PERFORMANCE

Continuous Discharge Current	140A
Maximum continuous Discharge Current	250A
Peak discharge Cut-Off Current	850A
Recommended Low Voltage Disconnect	10V
Discharge Cut-Off Voltage	> 8.4V
Reconnect Voltage	9.2V
Short Circuit Protection	Yes

CHARGE PERFORMANCE

Recommended Charge Current	140A
Maximum Chargent	250A
Recommended Charge Voltage	14.6 V
Charge Cut-Off Voltage	<15.2 V
Reconnect Voltage	>14.4V
Balancing Voltage	<14 V

MECHANICAL PERFORMANCE

Dimension (L x W x H)	453X238X221mm
Approx. Weight	28.5kg
Terminal Type	M8
Case Material	ABS
Enclosure Protection	IP65

TEMPERATURE PERFORMANCE

Discharge Temperature	-20~ 55°C
Charge Temperature	0~55°C
Storage Temperature	-20~ 25°C
High Temperature Cut-Off	90±5°C
Reconnect Temperature	65±10°C

COMPLIANCE

Certifications	UL CE UN38.3
Shipping Classification	UN 3480,MSDS

OUTLINE DIMENSION

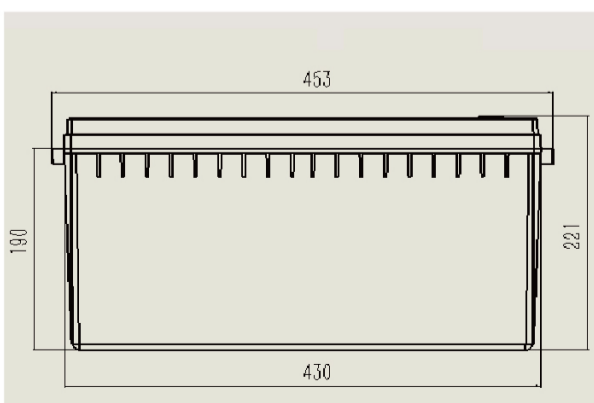

L:453mm

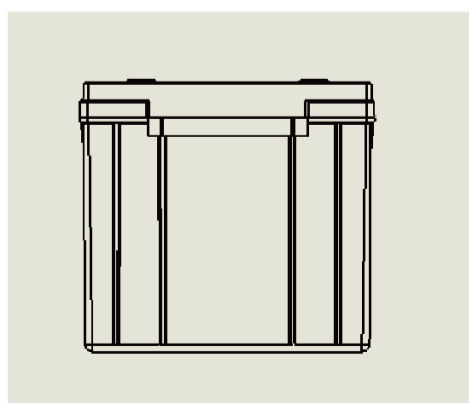

H:221mm

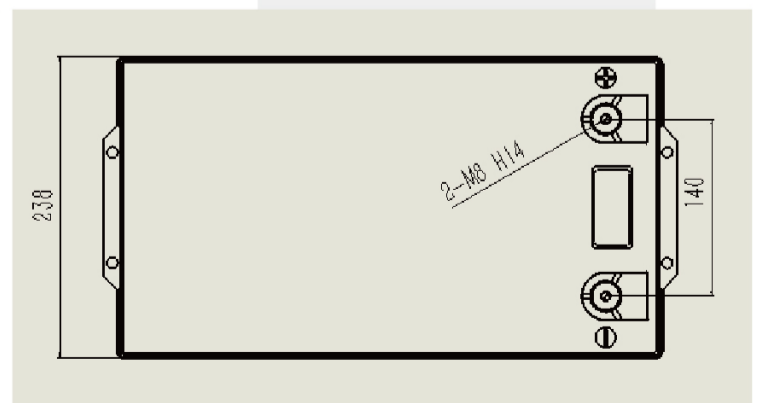

W:238mm