



# CST ENERGY



## 12.8V 280Ah LiFePO<sub>4</sub> Battery

### FEATURES & BENEFITS



#### High cycle life

>3000 cycles @80% DoD for effectively lower total cost of ownership.



#### Built in circuit protection

Battery Management Systems (BMS) are incorporated against abuse.



#### Light weight

Lithium batteries provide more Wh/Kg while also being up to 1/3 the weight of its SLA equivalent



#### Extreme heat tolerance

Suitable for use in a wider range of applications where ambient temperature is unusually high: up to +60°C.



#### Longer service life

Low maintenance batteries with stable chemistry. Easily monitor state of charge (SoC) of smart models.



#### Better storage

Up to 6 months thanks to its extremely low self discharge (LSD) rate and no risk of sulphation.



#### Quickly recharge

Save time and increase productivity with less down time thanks to superior charge/discharge efficiency.



#### Leading technology

We are a lithium battery brand originating from Germany and holding German patent certification

### PERFORMANCE CHARACTERISTICS

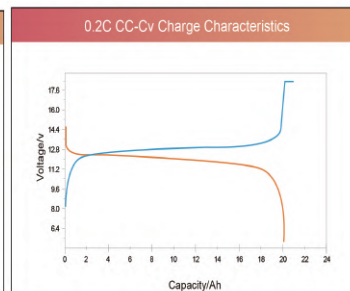
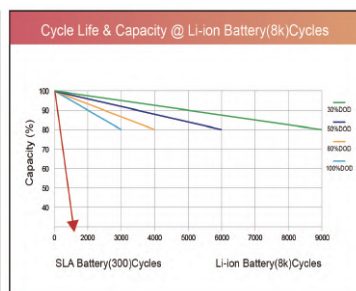
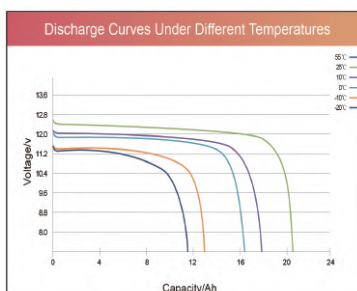
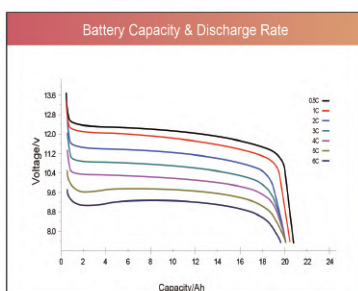



CST ENERGY

MODEL: CST-LT-12.8-280

### ELECTRICAL PERFORMANCE

Nominal Voltage	12.8V
Nominal Capacity	280Ah
Energy	3584Wh
Resistance	$\leq 1.204\text{m}\Omega$
Self Discharge	SOC < 3% / Month
Life Cycle	> 3000Cycles

### DISCHARGE PERFORMANCE

Continuous Discharge Current	140A
Maximum continuous Discharge Current	250A
Discharge Cut-Off Current	900A(100mS)
Recommended Low Voltage Disconnect	10V
Discharge Cut-Off Voltage	>8.4V
Reconnect Voltage	10.4V
Short Circuit Protection	Yes

### CHARGE PERFORMANCE

Recommended Charge Current	140A
Maximum Charge Current	250A
Recommended Charge Voltage	14.6V
Charge Cut-Off Voltage	<15.2V
Reconnect Voltage	>14.4V
Balancing Voltage	<14V

### MECHANICAL PERFORMANCE

Dimension (L x W x H)	453X238X221mm
Net. Weight	28.5kg
Terminal Type	M8
Case Material	ABS
Enclosure Protection	IP65

### TEMPERATURE PERFORMANCE

Discharge Temperature	-20~55°C
Charge Temperature	0~55°C
Storage Temperature	-20~25°C
High Temperature Cut-Off	90±5°C
Reconnect Temperature	65±10°C

### COMPLIANCE

Certifications	UL CE UN38.3
Shipping Classification	UN 3480,MSDS



### OUTLINE DIMENSION

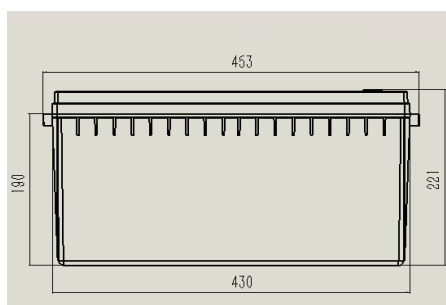

L:453mm

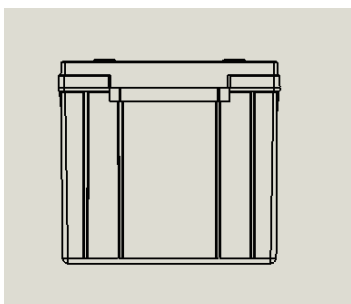

H:221mm

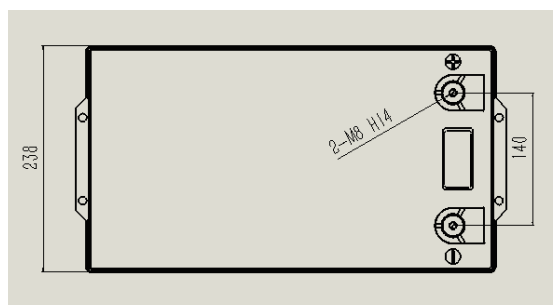

W:238mm